

LED Parking Garage Light

100-175W Replacement

- Saves up to 75% of energy usage
- Long life of 70,000+ hours with no bulb replacement
- Highly durable; lasts 60 times longer than traditional lighting
- Made in America and ARRA-Compliant
- Cutting-edge "heat sink" technology keeps the LEDs at their optimum performance temperature and extends product life



Features

- | | |
|--|--|
| <ul style="list-style-type: none"> • Applications: LED light for parking structures, commercial/industrial warehouses and low-bay applications, cold storage, manufacturing, and dock lighting. • Light Distribution: Type V • Input Wattage: Available in 60, 75 or 90 LED Watts • L70: 70,000+ hours • Durability: Powdercoat finish suitable for maritime environments; 2500-hour sea salt spray test | <ul style="list-style-type: none"> • Efficacy: Up to 70 lumens per watt • CRI: 70 or above • Listings/Ratings:    IP55 • Warranty: Manufacturer warrants products to be free from defects for a period of five (5) years. Please refer to complete warranty and terms and conditions document. |
|--|--|

Specifications

- | | |
|--|--|
| <p>Construction:
Luminaire is constructed of a one-piece cast, low-copper (<0.4%CU) aluminum alloy.</p> <p>Lens:
The lens is a polycarbonate prismatic refractor designed to shield the LED source and reduce glare at optimum angles.</p> <p>Gasketing:
Silicon gasket ensures moisture and dust-free enclosure.</p> <p>LED Module:
The LED light engine utilizes an aluminum metal-clad board for maximum heat transfer, leading to longer life. The module consists of various secondary optics allowing direction and intensity of the light to be tightly controlled. Control of the LEDs allows EvoLucia fixtures to maintain light levels equal to or greater than that of MH and HPS fixtures at much lower energy consumption levels and with an expected life that is greater than 50,000+ hours at a 25°C operating temperature.</p> | <p>LED Driver:
The LED driver is a constant-current device with a high-power factor correction to maximize power utilization. The driver meets UL 1310/UL 48 Class 2 with built-in over-temperature protection. Drive current not to exceed 277. Driver lifetime is rated at 100,000 hours.</p> <p>Finish/Color:
Finish is TGIC thermoset polyester powder coat paint, 2.5 mil nominal thickness; A.S.T.M. B-119, 2500-hour salt spray test endurance rating. The standard color is bronze. Custom colors are available; consult factory.</p> <p>Installation:
Fixture mounts to recessed outlet box or can be surface-mounted. Fixture features 5 one-half inch (1/2") knockouts for mounting.</p> |
|--|--|



* All data subject to change without notice.

Reference www.EvoLuciaLighting.com or contact sarasota@sunoviaenergy.com for additional information. REV 01-2011
 106 cattlemen road • sarasota fl 34232 • (941) 751-6800 • www.evoluminalighting.com

© 2011 EvoLucia Inc.

Project:	Approval:
Specifier:	

Technical Specifications

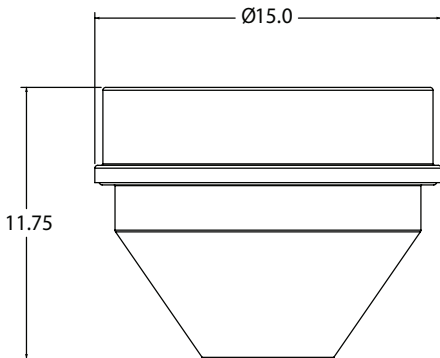

EPA: n/a **Height:** 11.75"
Weight: 13 lbs **Diameter:** 15"

Order Code

PS14	/	/	/	/	/
Family	Wattage-Color Temp	Distribution Type	Input Voltage	Finish	
	60-45 = 60W, 4500K	T5 = Type V	UNV = 100-277 VAC	BZ = Bronze	
	75-45 = 75W, 4500K		347 = 347 VAC	CC = Custom (Consult Factory)	
	90-45 = 90W, 4500K				
	65-60 = 60W, 6000K				
	75-60 = 75W, 6000K				
	90-60 = 90W, 6000K				

To view photometric test reports and download IES files, visit evolucialighting.com/technicallibrary.

* All data subject to change without notice.

Reference www.EvoLuciaLighting.com or contact sales@sunoviaenergy.com for additional information. REV 01-2011
 106 cattlemen road • sarasota fl 34232 • (941) 751-6800 • www.evolucialighting.com
 © 2011 EvoLucia® Inc.

EvoLucia
 AIMED LED LIGHTING
 a sunovia company