

LED Parking Structure Light

100-175W Replacement

www.evoluminalighting.com

- Saves up to 75% of energy usage
- Long life of up to 70,000+ hours with no bulb replacement
- Highly durable; lasts 6 times longer than traditional HID lighting
- Cutting-edge "heat sink" technology keeps the LEDs at their optimum performance temperature and extends product life



Features

- **Applications:** LED light for parking structures, commercial/industrial warehouses and low-bay applications, cold storage, manufacturing, and dock lighting.
- **Light Distribution:** Type V
- **Input Wattage:** Available in 60, 75 or 90 Watts
- **L70 Life Expectancy:** 70,000+ hours
- **Durability:** Powdercoat finish suitable for maritime environments.
- **Efficacy:** Up to 75 lumens per watt
- **CRI:** 70 or above
- **Listings/Ratings:**    **IP55**
- **Warranty:** Manufacturer warrants products to be free from defects for a period of five (5) years. Please refer to complete warranty and terms and conditions document.

Specifications

Construction:

Luminaire is constructed of a one-piece cast, low-copper (<0.4%CU) aluminum alloy.

Lens:

High impact polycarbonate prismatic refractor designed to shield the LED source and reduce glare at optimum angles.

Gasketing:

Silicon gasket ensures moisture and dust-free enclosure.

LED Module:

The LED light engine utilizes an aluminum metal-clad board for maximum heat transfer, leading to longer life. The module consists of various secondary optics allowing direction and intensity of the light to be tightly controlled. Control of the LEDs allows EvoLucia fixtures to maintain light levels equal to or greater than that of MH and HPS fixtures at much lower energy consumption levels and with an expected life that is greater than 50,000+ hours at a 25°C operating temperature.

LED Driver:

The LED driver is a constant-current device with a high-power factor correction to maximize power utilization. The driver meets UL 1310/UL 48 Class 2 with built-in over-temperature protection. Drive current not to exceed 277. Driver lifetime is rated at 100,000 hours.

Finish/Color:

Finish is TGIC thermoset polyester powder coat paint, 2.5 mil nominal thickness. The standard color is bronze. Custom colors are available; consult factory.

Installation:

Fixture mounts to recessed outlet box or can be surface-mounted. Fixture features 5 one-half inch (1/2") knockouts for mounting.



Advantage!
www.gsaadvantage.gov

* All data subject to change without notice.

Reference www.EvoLuciaLighting.com or contact sales@sunoviaenergy.com for additional information. REV 01-2011
106 cattlemen road • sarasota fl 34232 • (941) 751-6800 • 1-866-806-7868 • www.evoluminalighting.com

© 2011 EvoLucia® Inc.

Project:	Approval:
Specifier:	

Technical Specifications

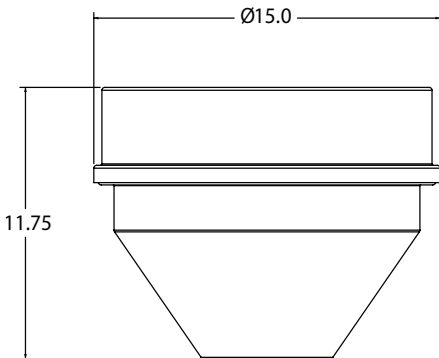

EPA: n/a **Height:** 11.75" (29.85 cm)
Weight: 13 lbs (5.90 kg) **Diameter:** 15" (38.10 cm)

Order Code

PS14	/	/	/	/	/	/
Family	Wattage-Color Temp	Distribution Type	Input Voltage	Finish	Options	
	60-45 = 60W, 4500K 75-45 = 75W, 4500K 90-45 = 90W, 4500K 60-60 = 60W, 6000K 75-60 = 75W, 6000K 90-60 = 90W, 6000K	T5 = Type V	UNV = 100-277 VAC	BZ = Bronze CC = Custom (Consult Factory)		

To view photometric test reports and download IES files, visit evolucialighting.com/technical-library

* All data subject to change without notice.

Reference www.EvoLuciaLighting.com or contact sales@sunoviaenergy.com for additional information. REV 01-2011
 106 cattlemen road • sarasota fl 34232 • (941) 751-6800 • 1-866-806-7868 • www.evolucialighting.com
 © 2011 EvoLucia® Inc.

